



INSTALLATION INSTRUCTIONS

Accessory	Application	Publications No.
XM SATELLITE RADIO SYSTEM (EX)	2007 PILOT	All 33093
		Issue Date AUG 2006

PARTS LIST

XM Radio Attachment (sold separately)
P/N 08B15-S9V-100A

2 Tuner brackets

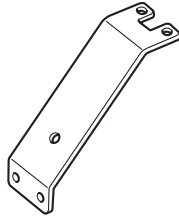

BUS cable

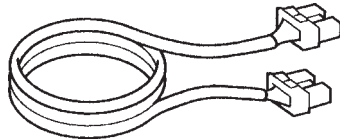

2 Cushion tapes

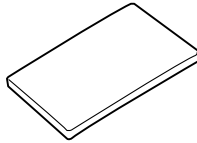

EPT sealer
(not used)

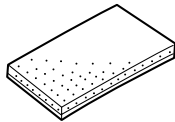

18 Wire ties

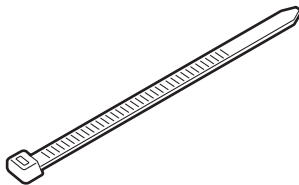

Wire tie with clip

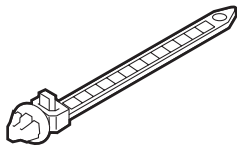

4 Flange bolts, 6 x 12 mm

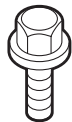

4 Washer-screws, 5 x 8 mm



Pillar clip



XM Antenna (sold separately)
P/N 08A15-0J1-100

Antenna

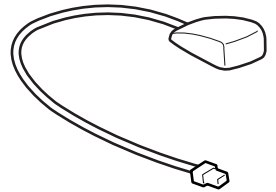

XM Unit (sold separately)
P/N 08A15-3J1-000

XM tuner

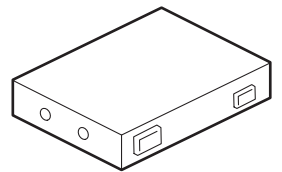

TOOL AND SUPPLIES REQUIRED

#2 Phillips screwdriver
Flat-tip screwdriver
Utility knife
Tape measure
Shop towel
Scissors
Ratchet
10 mm and 14 mm Socket
10 mm and 14 mm Combination wrenches
Felt-tip pen
Isopropyl alcohol
(Isopropyl alcohol, in a 60/40 solution with water)
T25 TORX bit

Illustration of the XM Satellite Radio Installed on the Vehicle

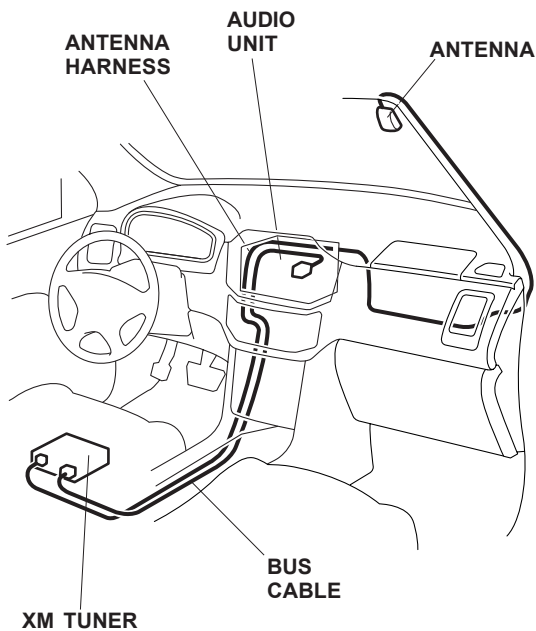

INSTALLATION

Customer Information: The information in this installation instruction is intended for use only by skilled technicians who have the proper tools, equipment, and training to correctly and safely add equipment to your vehicle. These procedures should not be attempted by "do-it-yourselfers."

1. Make sure you have the anti-theft code for the radio, then write down the frequencies for the preset buttons.
2. Disconnect the negative cable from the battery.
3. Remove the cap from the right sun visor (four retaining tabs).

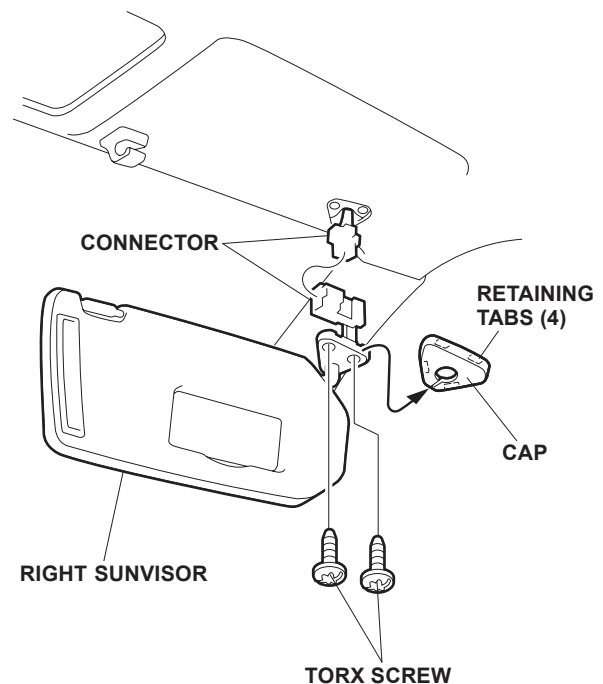

4. Remove the right sunvisor (two TORX screws and unplug the connector).

- Remove two caps from the right front grab rail and remove the grab rail (two screws).

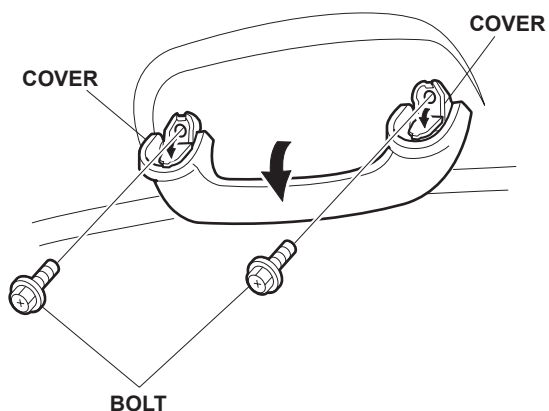

- Pull away the door weatherstrip from around the right front pillar trim. Using a small rubber mallet, and a shop towel, gently tap the right quarter pillar trim at the area marked "SIDE CURTAIN AIRBAG" to release the clip.

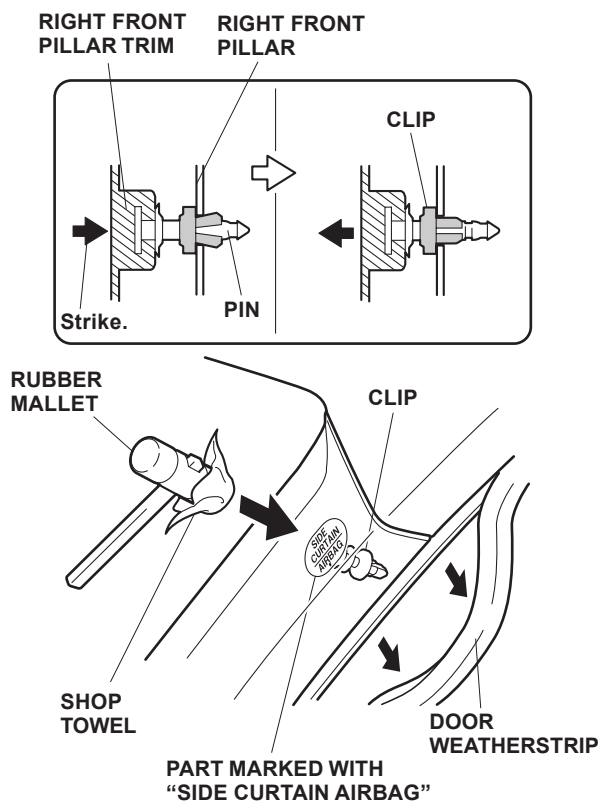

- Remove the door weatherstrip from the opening edge of the right front door in the area shown, then remove the right front pillar trim (one clip).

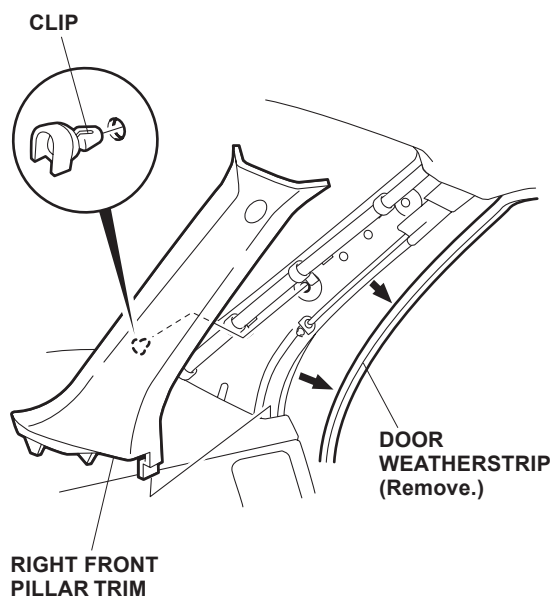

- Lower the glove box by removing the right and left stops.

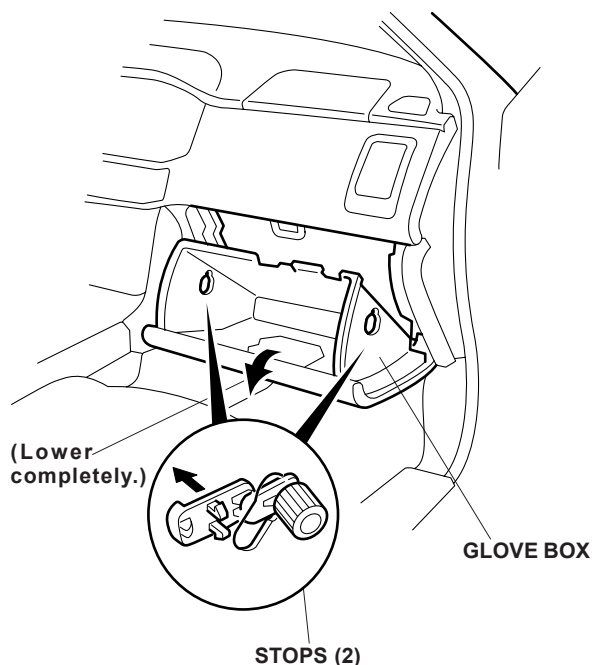

9. Remove the meter panel (two self-tapping screws and two clips).

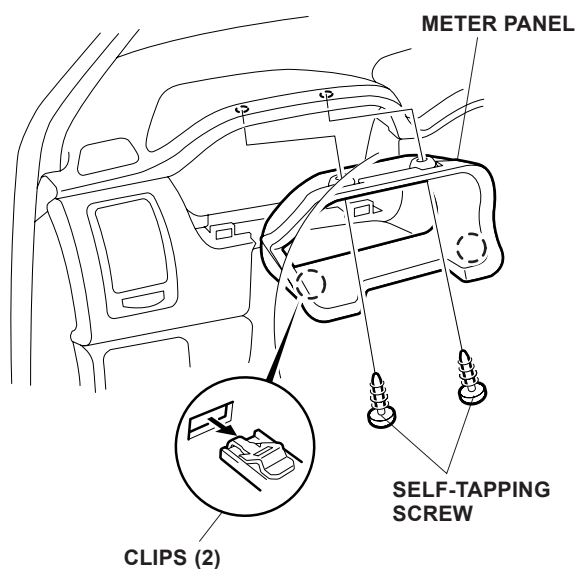

10. Remove the meter sub panel (three clips).

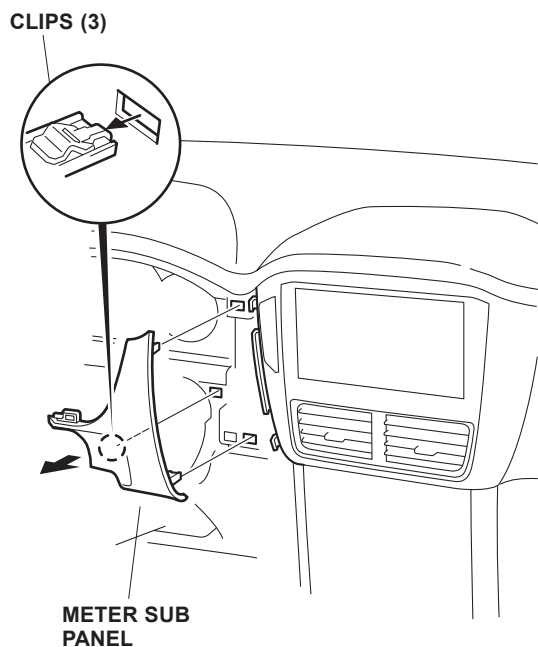

11. Gently pull out on the left side of the audio panel to release the two clips, then pull out to release the remaining three clips. Unplug the vehicle connectors and remove the audio panel.

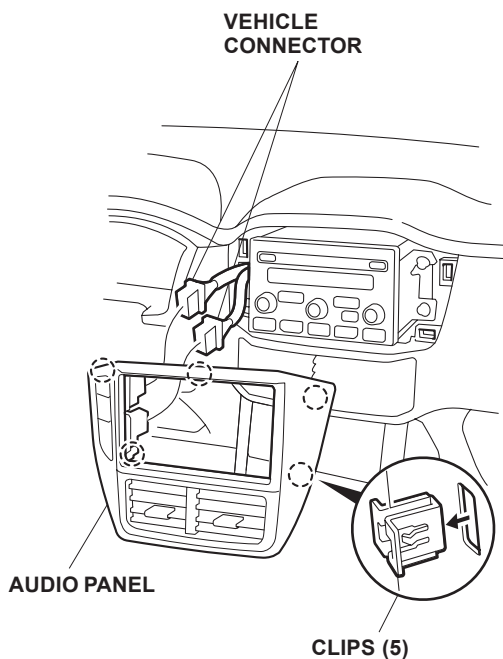

12. Remove the audio unit (four screws), pull the audio unit out toward you, unplug the vehicle connectors and vehicle antenna connector.

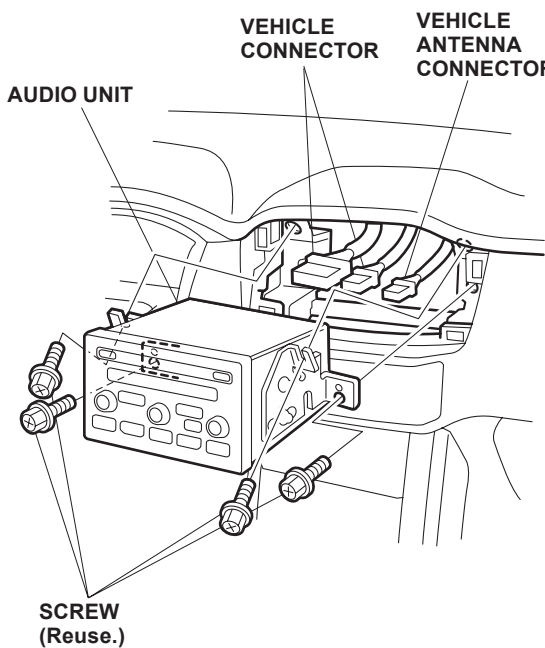

With Player

- Remove the driver's and passenger's center console trim pieces (three clips each). Take care not to damage the clips.

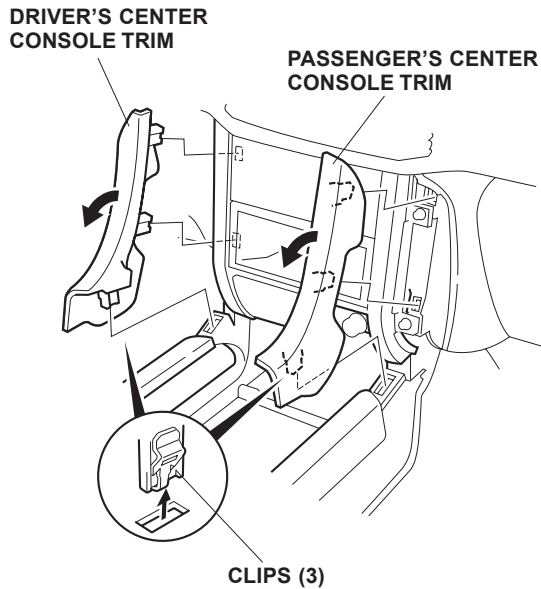

- Remove four self-tapping screws that fasten the center panel.

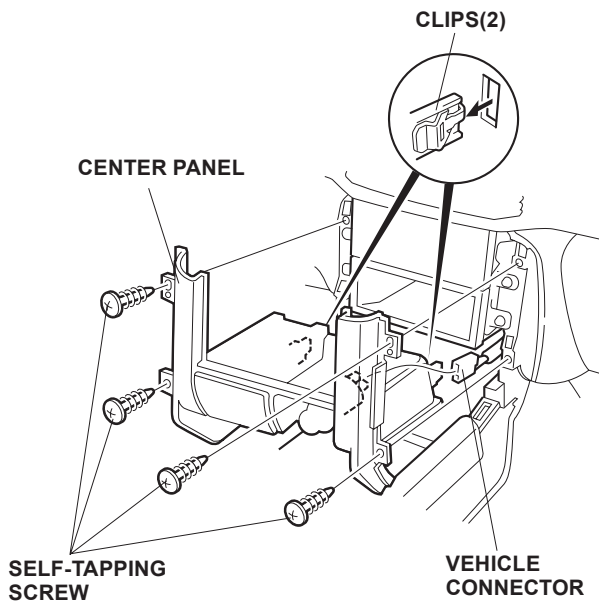

- Pull the center panel out toward you to release the two clips. Unplug the vehicle connector from the accessory socket, and remove the center panel.

- Remove four screws that fasten the left and right vehicle brackets. Pull the heater control unit and pocket out toward you, and unplug the vehicle connectors.

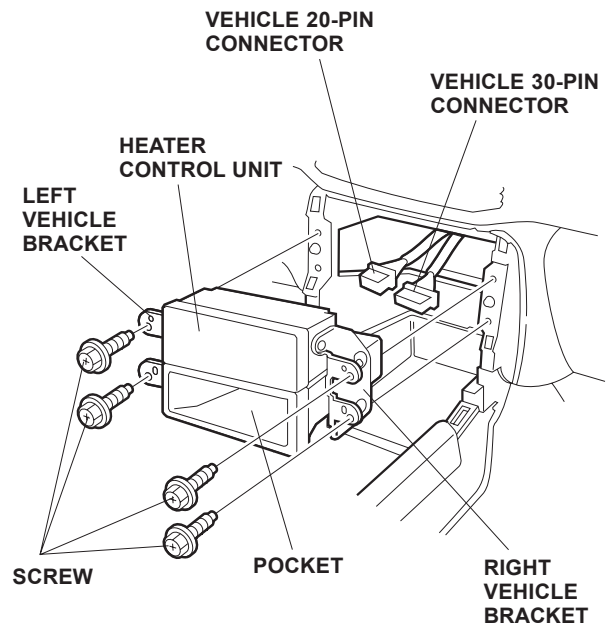

- Remove the driver's seat front cover from the driver's seat (four clips).

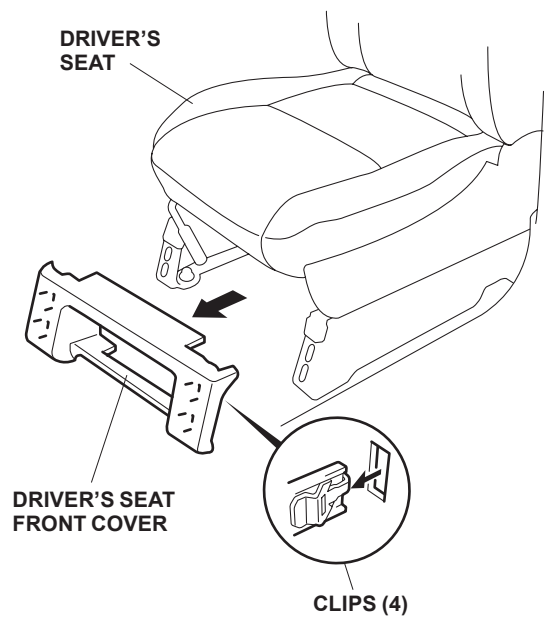

14. Remove the driver's seat rear cover from the driver's seat. Take care not to damage the clips.

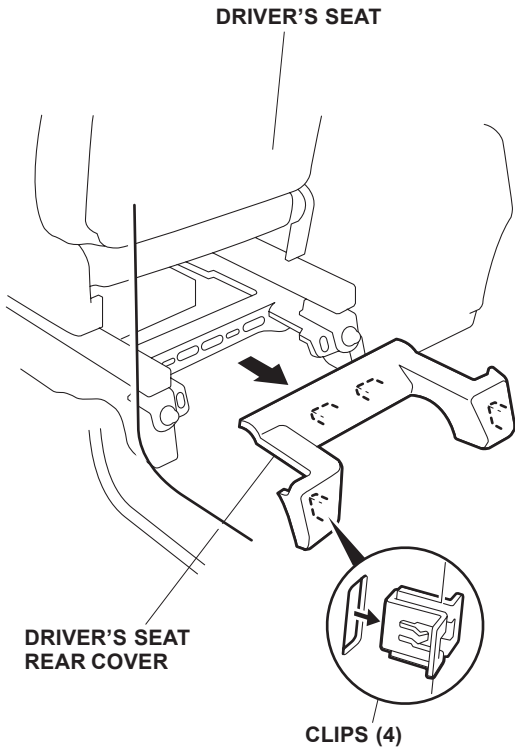

15. Remove the four bolts that secure the driver's seat side rails to the floor.

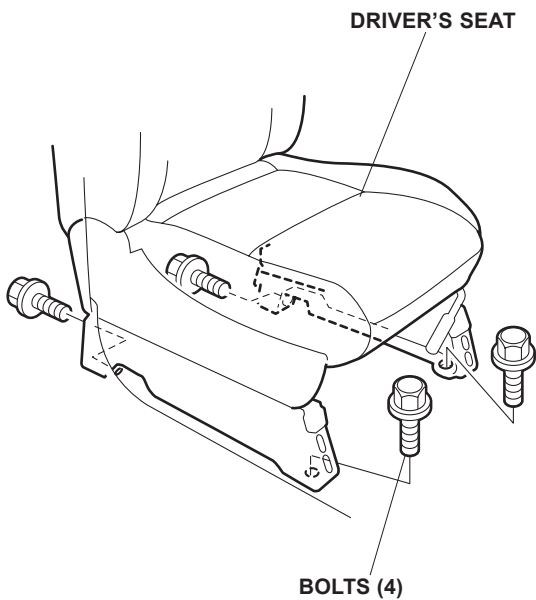

16. Remove the driver's center console lower cover (seven clips). Take care not to damage the clips.

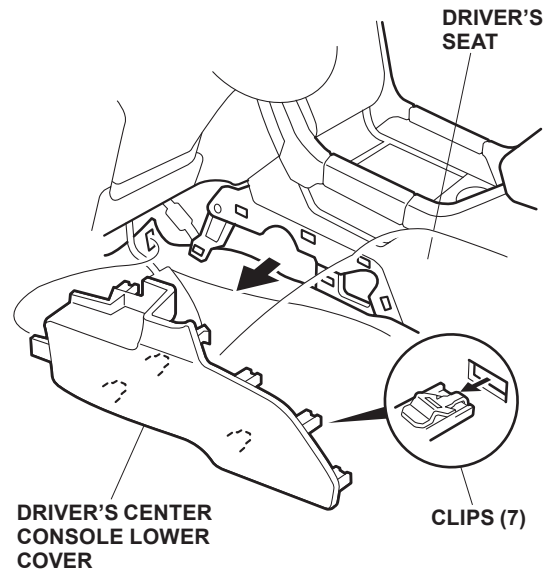

17. Using isopropyl alcohol, clean the windshield where the antenna will attach. Remove the adhesive backings from the antenna and attach the antenna to the front window at the location shown. Install the antenna by applying sufficient pressure.

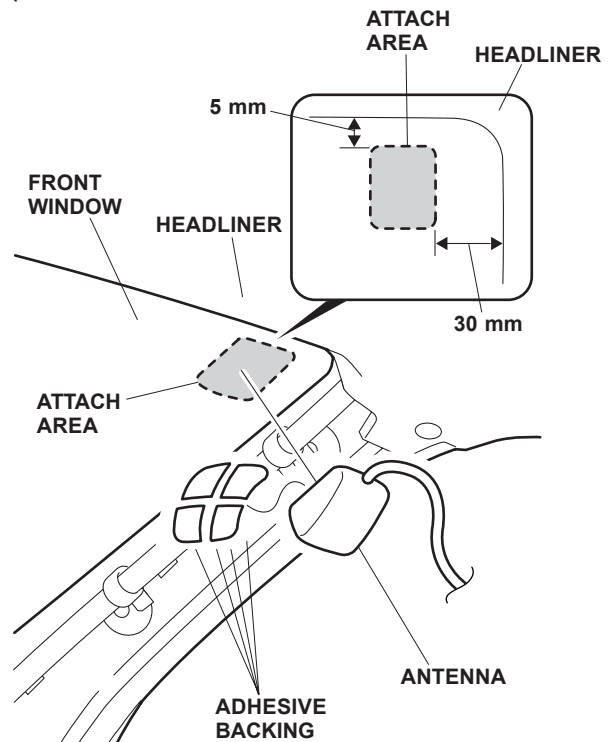

18. Route the antenna harness along the right front pillar and through the right front pillar trim opening. Secure the antenna harness to the vehicle harness with five wire ties.

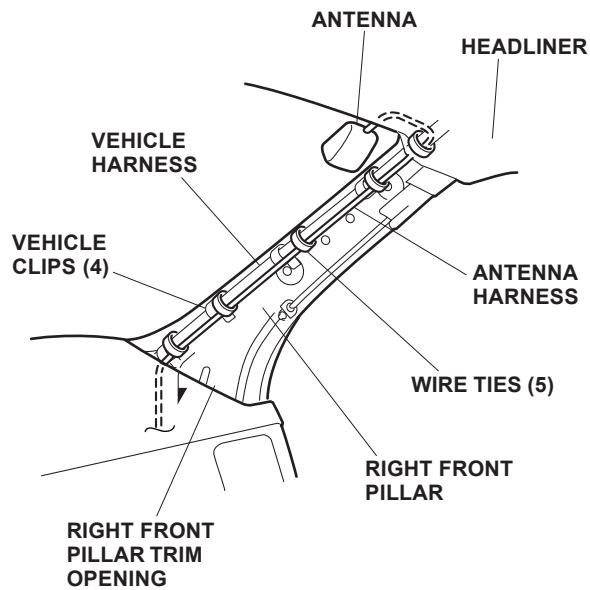

19. Route the antenna harness through the glove box opening and route it along the vehicle harness. Secure the antenna harness to the vehicle harness with four wire ties.

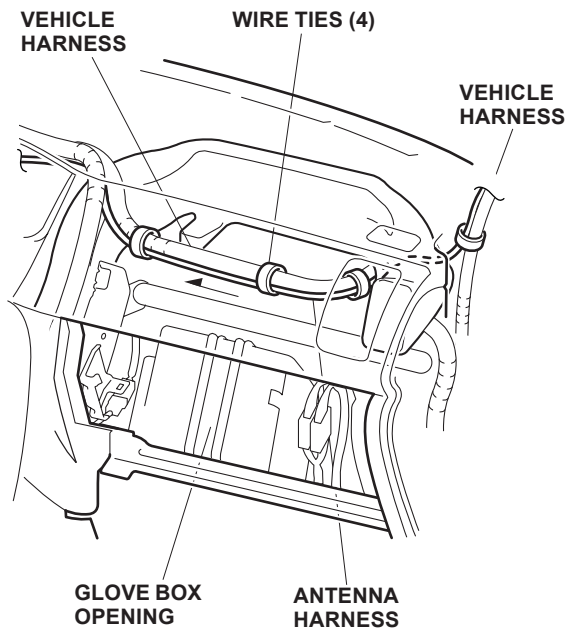

20. Route the antenna harness to the audio unit opening and secure it to the vehicle harness with one wire tie.

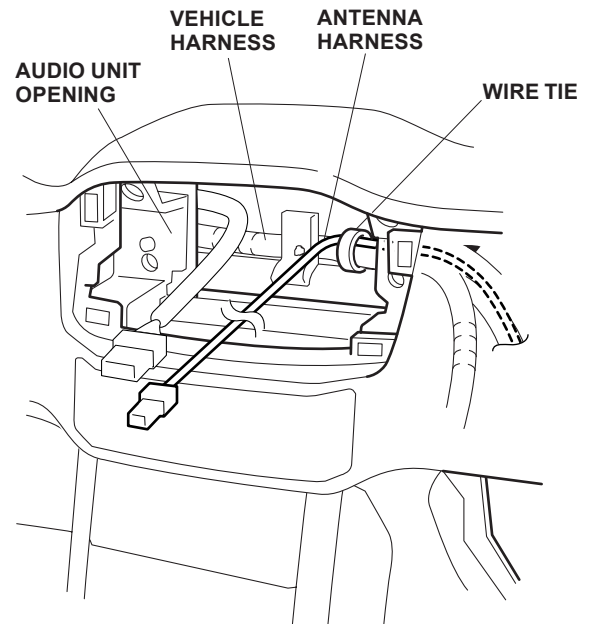

21. Continue routing the antenna harness and one end of the BUS cable through the radio opening and down along the vehicle harness. Align the other end of the BUS cable with the vehicle 20-pin connector. Then secure the antenna harness and BUS cable to the vehicle harness with one wire tie.

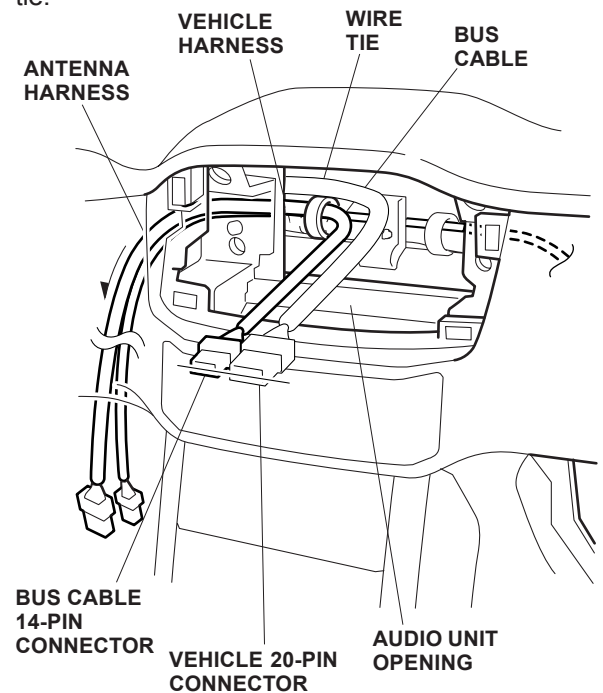

22. Route the antenna harness and BUS cable along the vehicle harness toward the floor, of the lower center console, and pull them out from under the driver's center console lower cover.

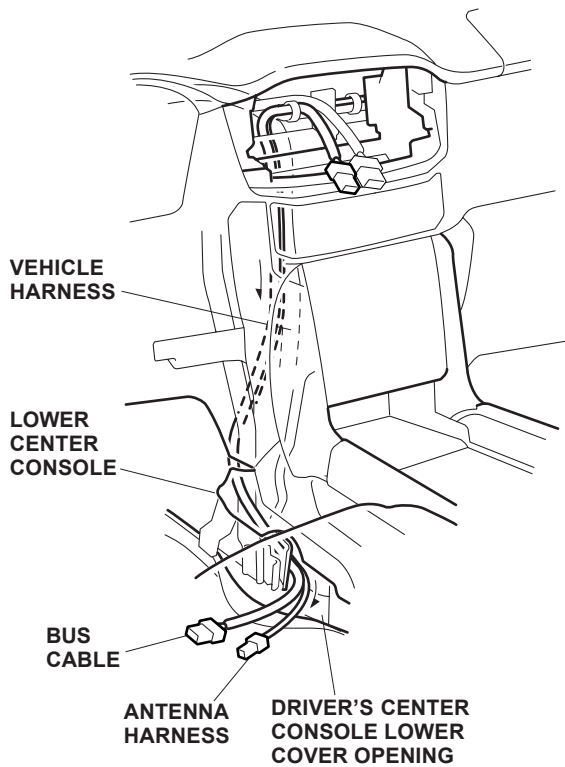

23. Secure the antenna harness and BUS cable to the vehicle harness and to the vehicle frame with two wire ties.

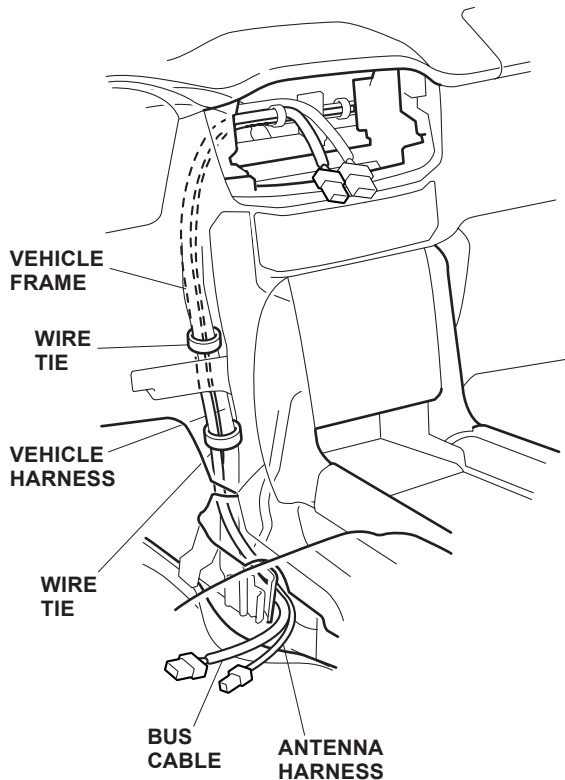

With Player

- Bundle the BUS cable with one wire tie as shown.

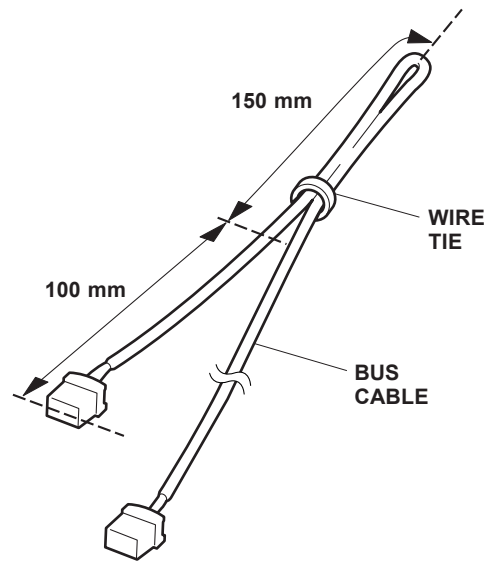

- Route the antenna harness along the vehicle frame .
- Pull the BUS cable out 100 mm from the vehicle wire tie through the heater control unit opening.
- Secure the BUS cable to the vehicle harness using one wire tie.

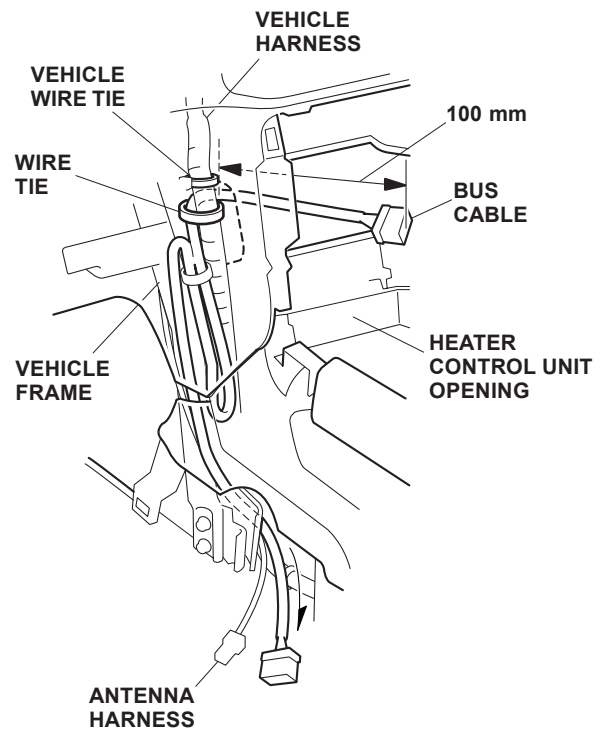

- Secure the antenna harness and BUS cable to the vehicle frame with three ties in the areas.

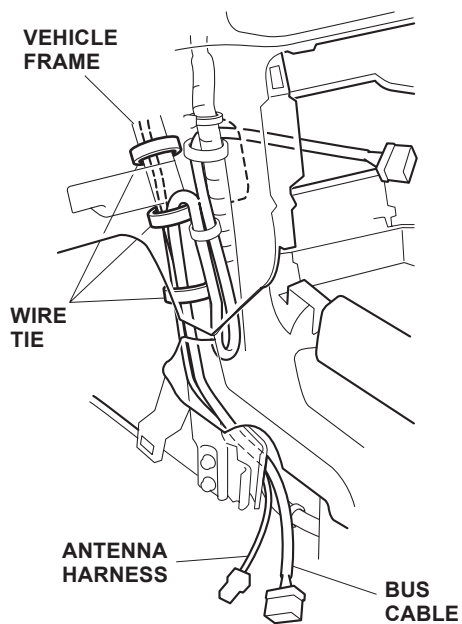

- Connect the bus cable 14-pin connector to the player.

Cassette Player

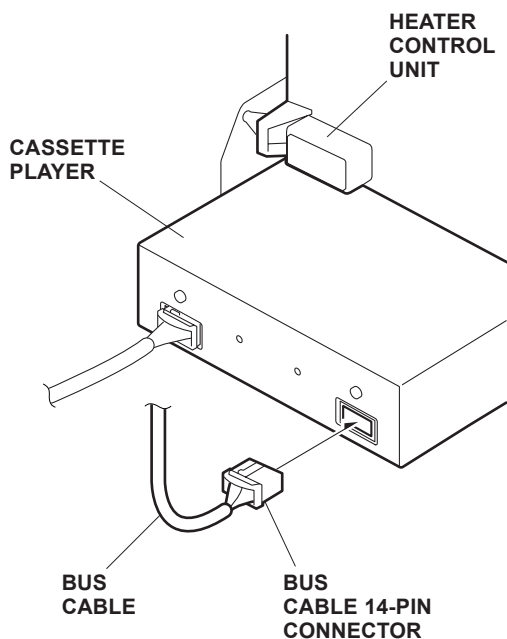

MP3 Player

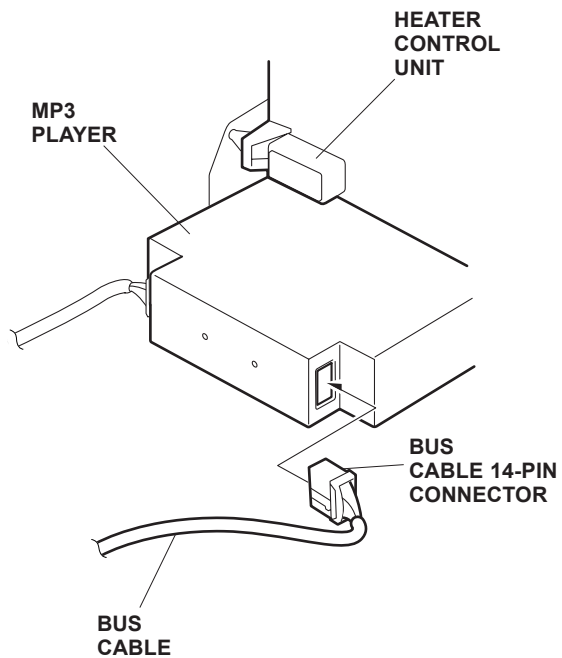

- Remove the two washer-screws from the dashboard.

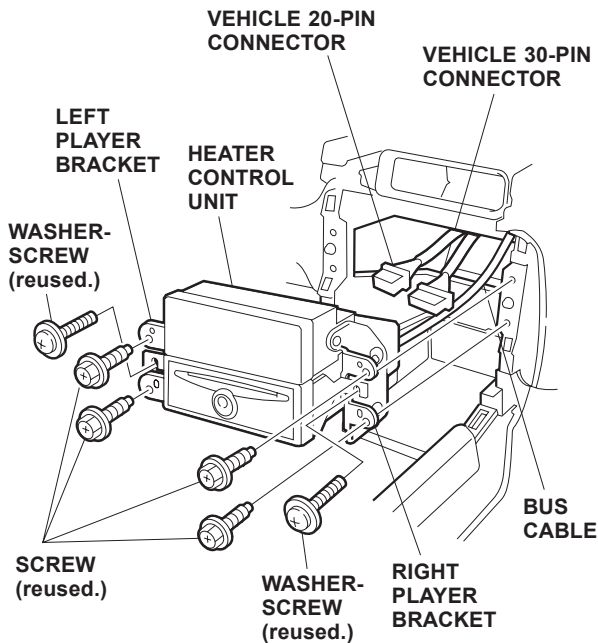

24. Plug the BUS cable 14-pin connector, vehicle connectors and vehicle antenna connector into the audio unit, then carefully slide the audio unit into the audio unit opening.

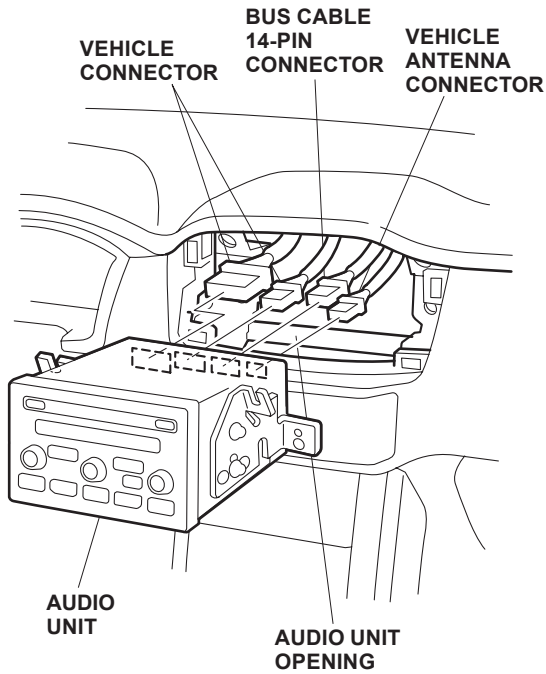

25. Reinstall the audio unit with four screws (you removed).

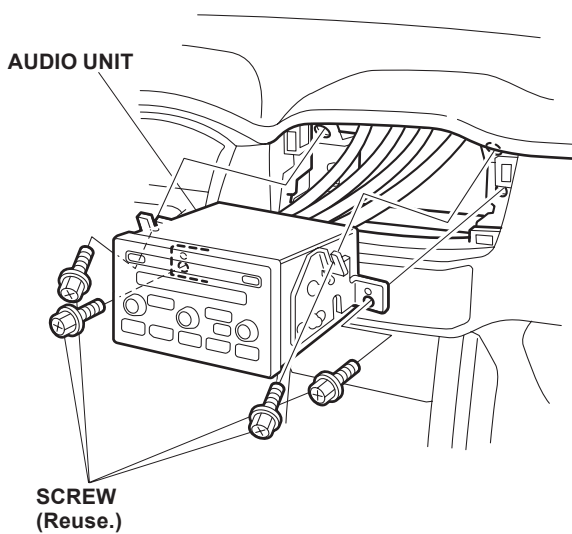

26. Using isopropyl alcohol on a shop towel, clean the vehicle frame where the cushion tapes will attach. Cut a cushion tape in half and attach the two halves of the cushion tape to the vehicle frame cleaned with isopropyl alcohol.

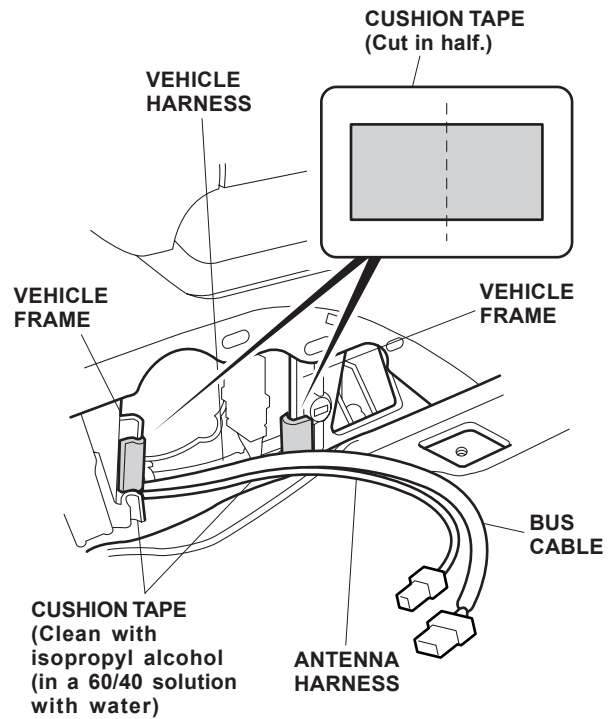

27. Measure and slit the driver's floor carpet area shown. Route the antenna harness and BUS cable under the floor carpet and out through the slit. Take care not damage to the antenna harness and BUS cable when cutting the floor mat.

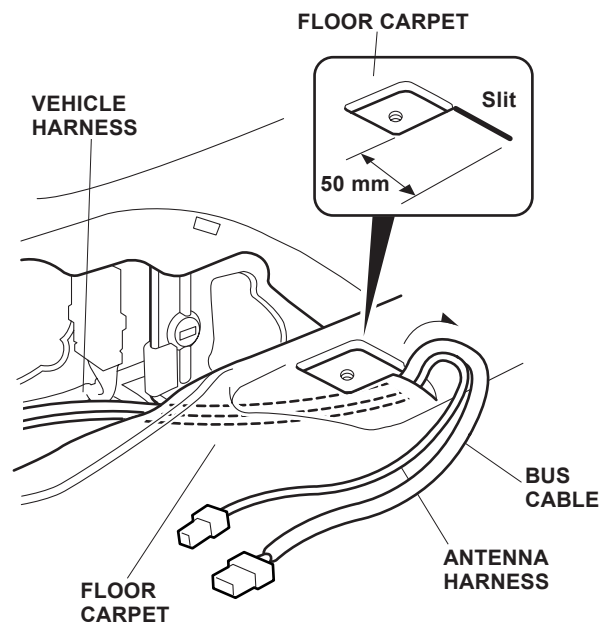

28. Attach the tuner brackets to the XM tuner with four 5 x 8 mm washer screws.

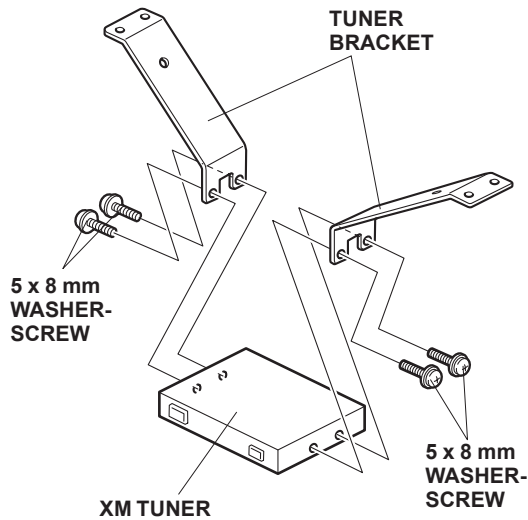

29. Using isopropyl alcohol, clean the area where the cushion tape will attach. Attach the cushion tape to the tuner bracket at the location shown.

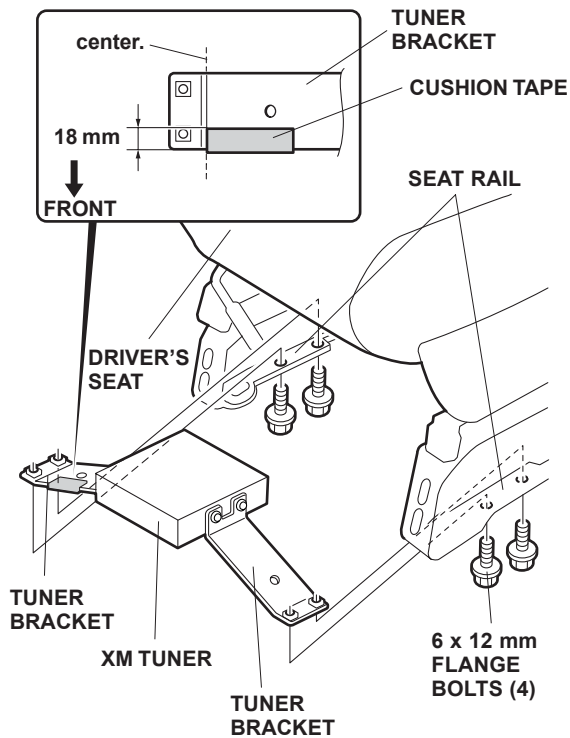

30. Install the tuner bracket to the driver's seat rails with the four 6 x 12 mm flange bolts. Tighten the bolts securely.

31. Plug the BUS cable 14-pin connector into the XM tuner 14-pin connector.

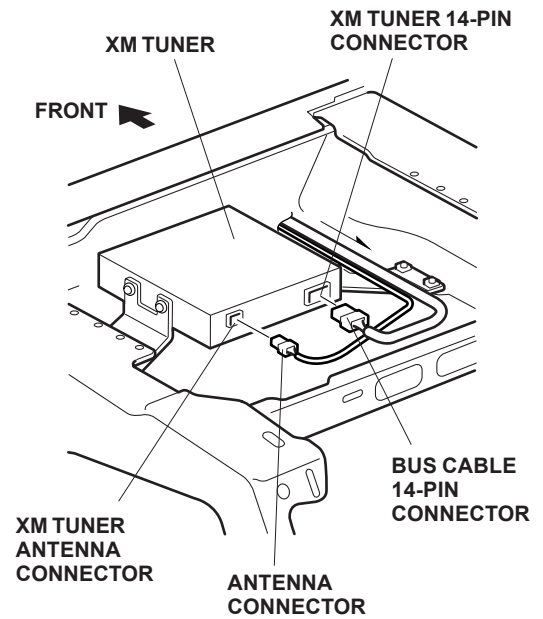

32. Plug the antenna connector into the XM tuner antenna connector.

33. Secure the BUS cable and the antenna harness to the tuner bracket with one wire tie with clip.

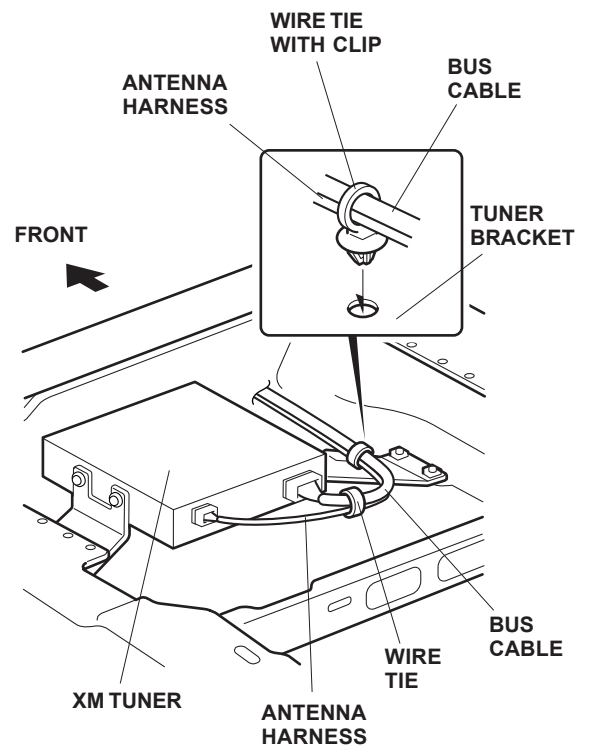

34. Secure the BUS cable and the antenna harness with one tie wire.

35. Bundle the excess of the antenna harness. Secure the antenna harness to the vehicle's harness using two wire ties.

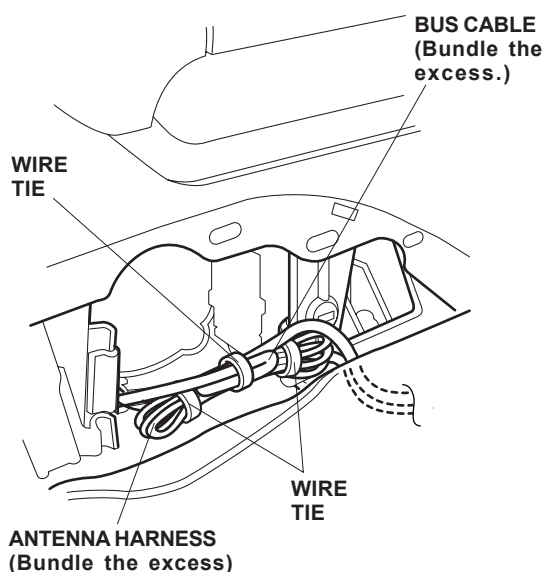

36. Bundle the excess of the BUS cable. Secure the BUS cable and the antenna harness to the vehicle's harness.

37. Check that all wire harnesses are routed properly and all connectors are plugged in.
38. Reinstall the driver's center console lower cover.
39. Reinstall the driver's seat. Take care not to pinch the any wires. Torque the seat bolts to 47 N-m (35 lb-ft).
40. Remove the clip from the top of the right front pillar trim, and install a new pillar clip.

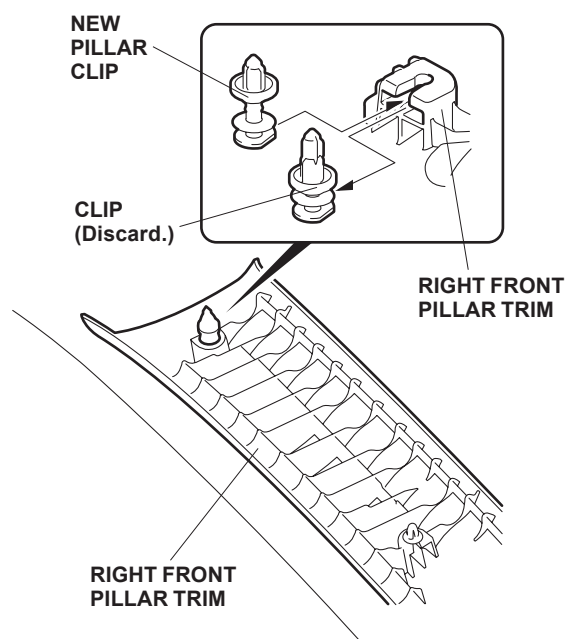

41. To install the pillar clip, position it at right angles to the right front pillar and install by lightly pushing on the area marked with "SIDE CURTAIN AIRBAG" on the right front pillar trim. Check that the pillar clip is not interfering with the airbag. Take care not to push the right front pillar trim excessively.
 42. Reinstall all removed parts.
 43. Reconnect the negative cable to the battery.
 44. Enter the customer's radio anti-theft code, and reset the radio station presets.
 45. Reset the clock.
- NOTE: Whenever the battery is disconnected, the driver's AUTO function is disabled.
46. Start the engine. Push down on the driver's window switch until the window is fully open.
 47. Pull up on the driver's window switch to close the window completely, then hold the switch for a second or 2 more.
 48. Test the AUTO window function.